

# Centinel washbasin

MODEL RANGE: TUBS-BASINS | G20131N | 203.0000.075

Washbasins & Washtroughs | Wash basins

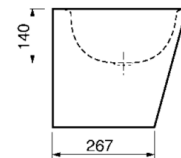
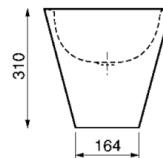
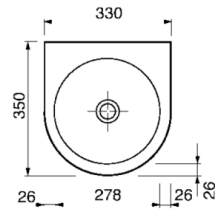

The Centinel washbasin is manufactured from 1.2mm thick grade En 1.4301 (304) stainless steel polished to a satin finish. The bowl is prepared for and supplied with a 32mm flush grated waste only (no overflow can be fitted). A single taphole is provided positioned at rear right hand side. Complete with bottom access panel for fixing (using bolts supplied) and plumbing connections.

1 taphole

Dimensions 330 x 310 x 350 mm (W x H x D)

## Technical data

Material thickness	1.20 mm
Overall depth	350.00 mm
Overall height	310.00 mm
Overall width	330.00 mm
Material	Stainless steel
Material code	1.4301 Chrome Nickel steel V2A
Tailor made	No
Tap hole position	Right
Tap ledge	Yes
Type of mounting	Wall mounting
Waste hole position	Center
Bowl finish	Satin finish
Bowl shape	Circle
Overflow	No
Rear upstand	No
Splash back	No
Surface finish	Satin finished
Number of tap holes	0.00000
Waste kit included	Yes
Waste size	DN 25
Product code	203.0000.075

# Centinel washbasin

MODEL RANGE: TUBS-BASINS | G20131N | 203.0000.075

Washbasins & Washtroughs | Wash basins

---

## Accessory Optional

---



---

**HEAVY-DUTY Toilet roll holder**

2000057081

HDTX674

---



---

**HEAVY-DUTY Paper towel dispenser**

2000057407

TD350

---