



D6R/75B - Lincat Seal 650 Series Counter-top Rectangular Front Refrigerated Merchandiser - Back-Service - W 750 mm - 0.6 kW

Enhance your food sales by showcasing sandwiches, baguettes, yoghurts, fruit and drinks in the Seal 650 Range Rectangular Front Refrigerated Merchandiser.

- ✔ Using precise thermostatic control this unit holds food from 3°C - 7°C. It enables the user to accurately monitor the temperature of product for the absolute best results
- ✔ Digital display which gives clear indication of temperature to the user
- ✔ The unit is double glazed which keeps the cool air locked in, this in turn gives the customer better results while also saving money through energy efficiency.
- ✔ The provides daylight balanced illumination which lights up the unit giving the product the spotlight
- ✔ Options for self service or back service are also available.
- ✔ Spacious unit enabling you to showcase a wide variety of product

Specifications

Summary

| | |
|-----------------------------|-----------------------------------|
| Brand | Lincat |
| Range | Seal |
| Series | 650 Series |
| Power Type | Electric |
| Unit Type | Counter-top |
| Available in UK Only | No |
| UK Warranty | 2 Years Parts and Labour Warranty |
| Export Warranty | Contact your local dealer |
| GTIN | 5056105104155 |

Power and Performance

| | |
|-----------------------------|------------|
| Total Power kW | 0.600 |
| Temperature Range °C | 3-7 |
| IP Rating | IP33 |
| Temperature Control | Electronic |

Key Specifications

| | |
|-----------------------------------|--------------|
| Number of Shelves included | 2 |
| Number of Shelf Positions | 2 |
| Refrigerant Type | R452a |
| Service Type | Back service |
| Type of Lighting | Fluorescent |

Weights and Dimensions

| | |
|----------------------------------|-----|
| Unit Height (External) mm | 965 |
| Unit Width (External) mm | 750 |
| Unit Depth (External) mm | 650 |
| Height (Internal) mm | 528 |
| Width (Internal) mm | 710 |
| Depth (Internal) mm | 570 |
| Shelf Dimensions Width mm | 650 |
| Shelf Dimensions Depth mm | 525 |
| Net Weight Kg | 85 |

Supply Connections

| | |
|---------------------------------------|------|
| Requires Installation | No |
| Requires Electrical Supply | Yes |
| UK 3 Pin Plug | Yes |
| Requires Hardwiring | No |
| Electrical Supply Rating Watts | 602 |
| Single Phase Amps | 2.60 |
| Single Phase Voltage | 230 |

Shipping

| | |
|-------------------------|-------|
| Packed Weight Kg | 107.6 |
| Packed Height cm | 110 |
| Packed Width cm | 100 |
| Packed Depth cm | 80 |

Technical Picture

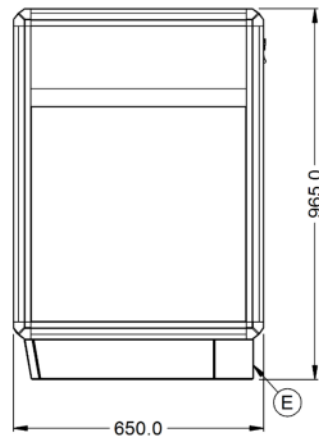
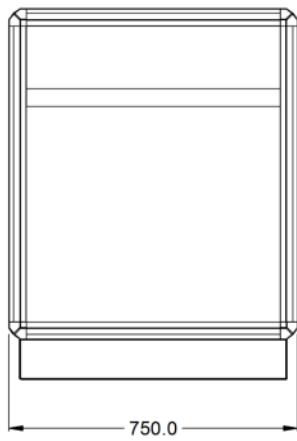
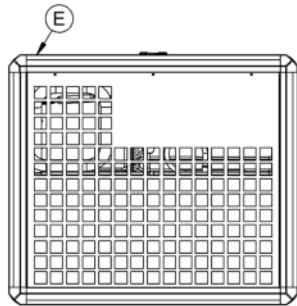



Lincat Limited

Whisby Road,
Lincoln, LN6 3QZ,
United Kingdom

Company No: 2175448

A member company of



Customer Care

Tel: +44 1522 875500
Email: care@lincat.co.uk

Export Customers

Tel: +44 1522 875536
Email: export@lincat.co.uk

Opening Hours

Monday – Friday:
8.30am – 5pm