

Fully Assembled Pre-Rinse Units - Product No's: 601H2O-FA, 601H2O-FA6, 601H2O-FA8 & 601H2O-FA12

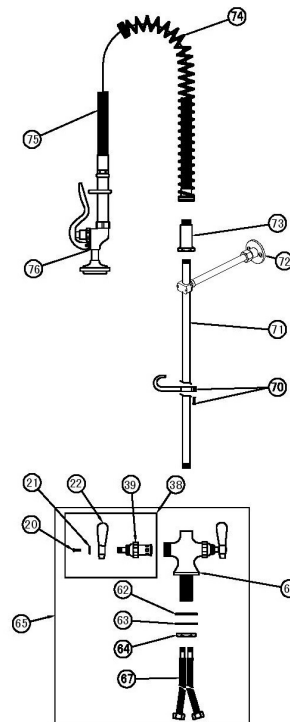

- Deck mounted double pre-rinse unit
 - Supplied with flexible hose, wall bracket and restraining wire
 - Optional bowl-filling tap (6", 8" or 12")
 - Pre-assembled ready for installation
 - High quality components for commercial use
 - WRAS approved
 - Replacement accessories available
-
- 8" (203mm) centre deck mount
 - 20" (510mm) riser brass pipe
 - 44" (1118mm) flexible stainless steel hose
 - Santoprene inner pipe
 - 6" (152mm) or 12" (305mm) wall bracket
 - Includes check valve to prevent cross flow
 - Spray valve conforms to ANSI/ASTM F2324-03
 - Flow rate is 8.9l/min @ 2 bar

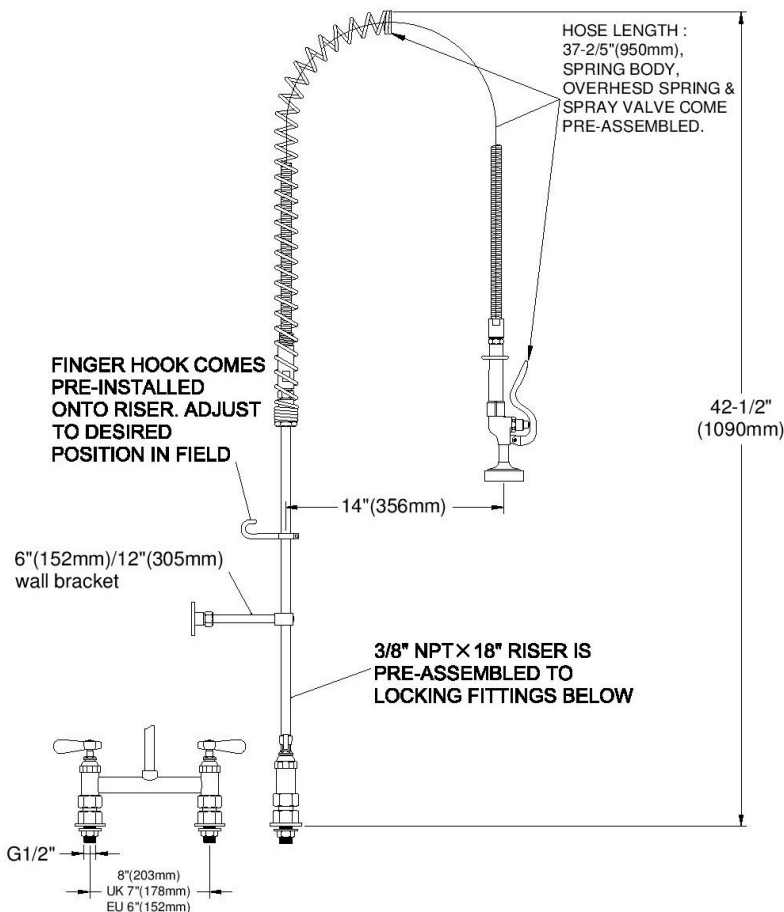

| | |
|----|-------------------------------|
| 20 | Screw, Lever, Handle |
| 21 | Index Button |
| 22 | Lever Handle |
| 38 | Asm, Lever Handle (LH) |
| 39 | Asm, Spdl LH-Eterna W/Spring |
| 62 | O-Ring |
| 63 | Level |
| 64 | Locknut, Shank |
| 65 | Asm, Body |
| 66 | Body, Faucet |
| 67 | Flexible Hose |
| 70 | Assembly, Finger Hook & Screw |
| 71 | Nipple. 3/8" x 24 |
| 72 | Wall Bracket |
| 73 | Spring Body |
| 74 | Spring, Overhead |
| 75 | Assembly Flex S/S Hose |
| 76 | Assembly Spray Valve |

In accordance with our policy of continued development we reserve the right to alter design and specifications without prior notification